



## Fairlea Place, W5

A large one-bedroom apartment situated on the ground floor of the popular Fairlea Place development and comes with private garage, 986-year lease and no onward chain.

Measuring over 500 sq. ft and presented in good order, the property consists of large reception leading directly onto large well groomed communal gardens, separate kitchen, double bedroom, family sized bathroom, excellent storage facilities and privately owned garage.

- Large one bedroom
- Ground floor
- Separate kitchen
- Family sized bathroom
- Private garage
- 986 years on Lease
- Direct access onto communal gardens
- No chain
- Popular location
- Close to transport links

£315,000

# Fairlea Place

Approximate Gross Internal Area  
506 sq ft - 47 sq m

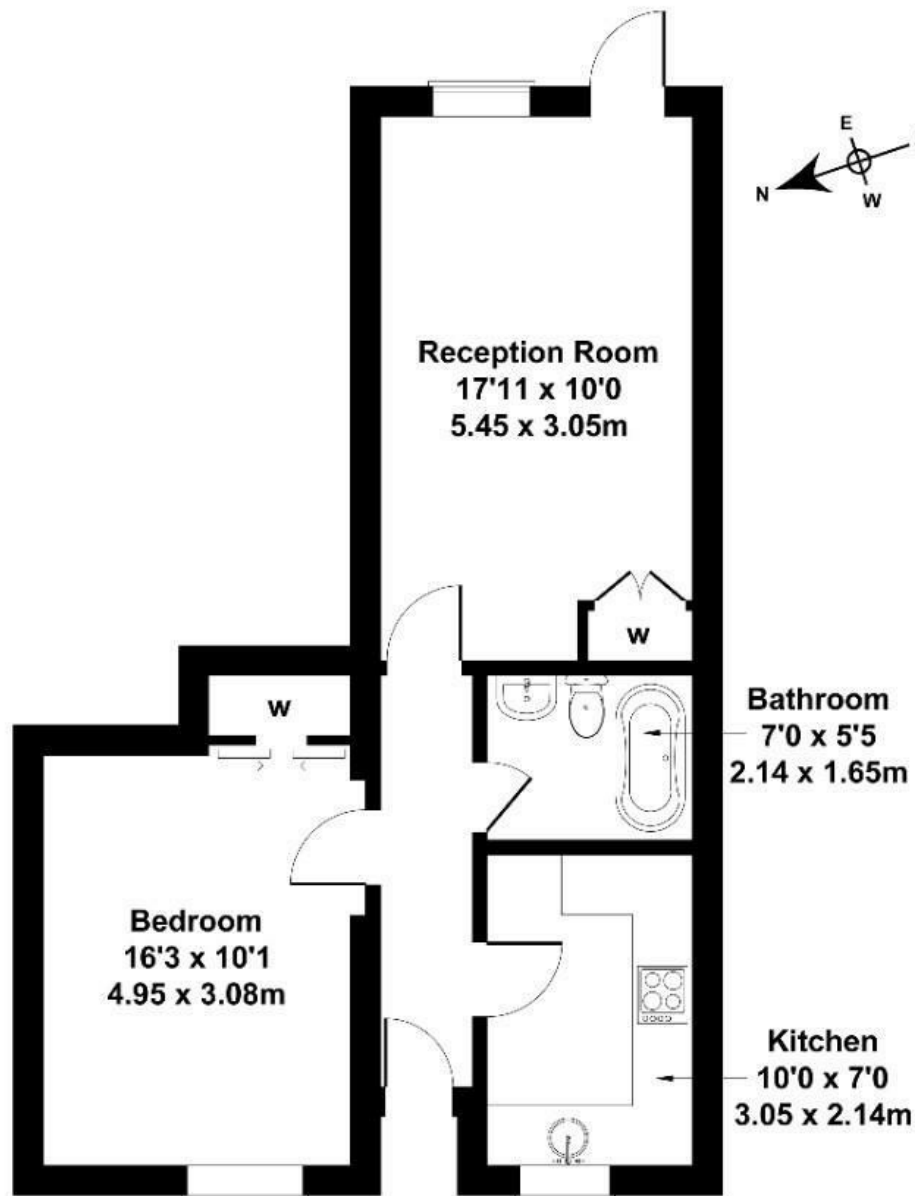

## GROUND FLOOR

Not to Scale. Produced by The Plan Portal 2025  
For Illustrative Purposes Only.

Energy Efficiency Rating		
	Current	Potential
Very energy efficient - lower running costs		
(92 plus) A		
(81-91) B		
(69-80) C		
(55-68) D		68
(39-54) E	52	
(21-38) F		
(1-20) G		
Not energy efficient - higher running costs		
England & Wales		EU Directive 2002/91/EC